



A Maxcess  
International  
Company

# SE-46 Digital Line Guide Sensor



## Reduce operating costs, increase line speed

**T**he SE-46 Digital Line Guide Sensor can improve efficiency in line guiding applications where other sensors suffer from lack of contrast or sufficient space between printed elements. This fast scanning, highly sensitive sensor features a wide spectrum light source to illuminate the web, a wide field of view, and high resolution to ensure reliable detection of existing one-dimensional graphics (i.e. bar codes), eliminating the need to print a separate striker line just for guiding.

Automatic setup of the SE-46 is achieved locally using convenient controls on top of the sensor or remotely using the D-MAX Series Web Guiding System. Simply position the sensor field of view on the chosen element and initiate automatic calibration.

## General Specifications

**Part Number:**  
SE-46 Digital Line Guide Sensor

**Power Required:** 12V / 24V  
(powered by a Fife controller)

**Output Signal:**  
Analog: 0 to 10 mA  
Digital: MaxNet over Ethernet

**Class:** IP-54

**Certification:** CE

**Temperature Range:**  
0° to 60° C (32° to 140° F)

**Minimum Line Width:**  
0.5 mm (0.020 inch)

**Maximum Line Width:**  
20 mm (0.787 inch)

**Proportional Band Width:**  
30 mm (1.181 inch)

**Clearance to Print:**  
0.2 mm (0.008 inch)

**Shortest Detectable Feature:**  
(3.7 mm = 600 m/min)

**Sensor Weight:**  
1.3 Kg (2.9 lbs)

# KEY FEATURES

## Key Features

- Fast scanning process allows for faster press speeds
- Highly sensitive diode array camera allows the use of existing printed elements for guiding
- Capable of detecting line, line edge, and one-dimensional graphic
- Fully automatic calibration and line targeting assistance simplify setup and operation
- Large field of view
- Compatible with all Fife digital or analog web guide controllers
- Digital signal output via Ethernet
- Remote or local control options

# Nomenclature and Dimensions

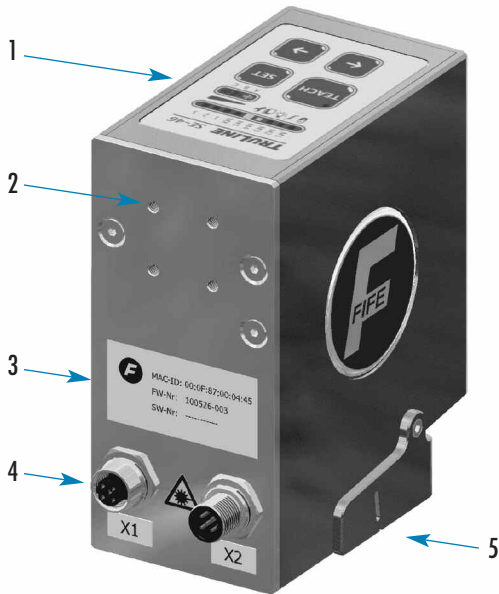

- 1 Keypad
- 2 FAMB Mounting
- 3 Software / Firmware Revision
- 4 Analog (X2) Connector Ethernet (X1) Connector
- 5 Sensing Area

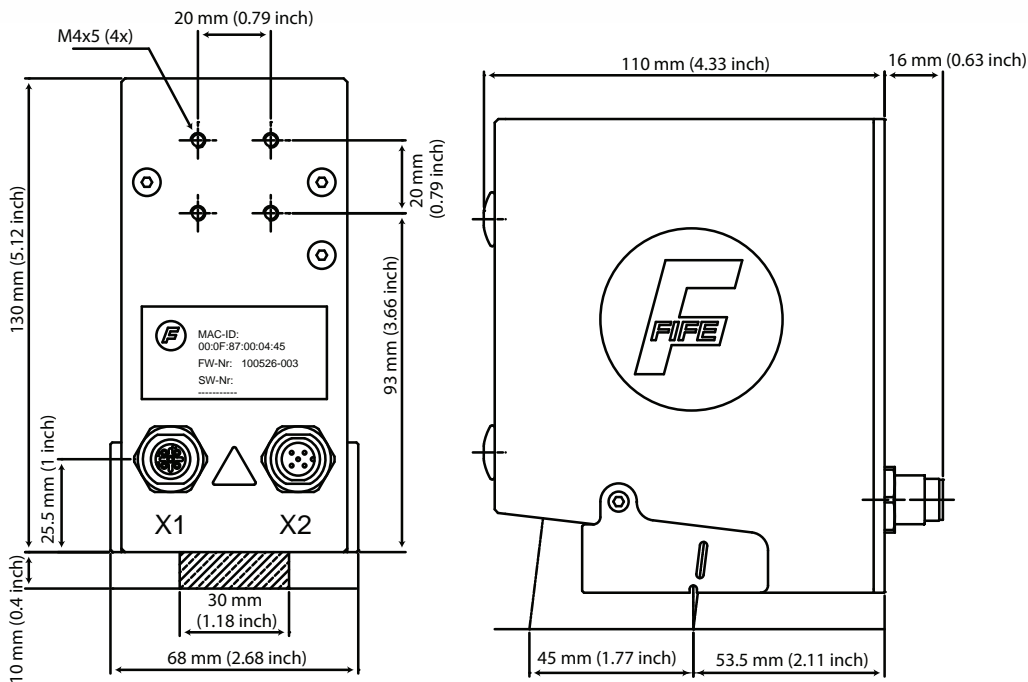
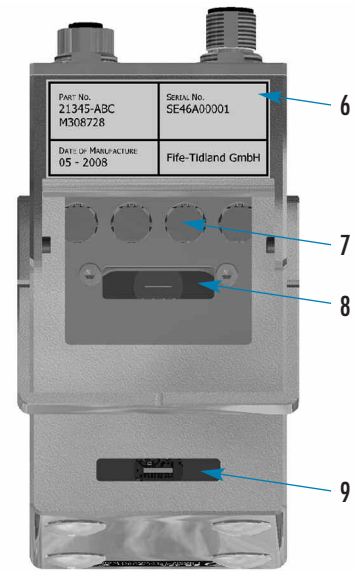

- Complementary Products:**
- FIFE**
- Guiding Products & Systems
    - D-MAX Series Guiding System
    - Offset Pivot Guides
  - Video & Visual Inspection
    - InPrint Video Inspection
- TIDLAND**
- Slitting Products & Systems
  - Winding Products
- MAGPOWR**
- Tension Control Products
  - Torque Control Products



A Maxcess International Company

**Fife Corporation**  
 222 West Memorial Road  
 Oklahoma City, OK 73114, USA  
 Phone: 405-755-1600  
 Fax: 405-755-8425  
 E-mail: fife@fife.com  
 Web: www.fife.com

**Fife-Tidland GmbH**  
 Fifestrasse 1, D-65779  
 Kelkheim/Ts., Germany  
 Phone: (49) 6195-7002-0  
 Fax: (49) 6195-7002-933  
 E-mail: info@maxcess.eu

**Maxcess Asia**  
 300 Orchard Road, No. 15-05  
 Orchard Towers  
 Singapore 238875  
 Phone: (65) 6834-1998  
 Fax: (65) 6835-4818  
 E-mail: asia@maxcessintl.com



MAXCESS INTERNATIONAL COMPANIES



**GUIDING · INSPECTION**  
 1-800-639-3433  
 (405) 755-1600



**TENSION CONTROL**  
 1-800-MAGPOWR  
 (405) 755-1600



**SLITTING · WINDING**  
 1-800-426-1000  
 (360) 834-2345